

Qty: 2 Ref: 13-9-RCAO Road Closed Access Only	
Qty: 2 Ref: 2702 End of temporary diversion route	
Qty: 2 Ref: 2702 Start of temporary diversion route	
Qty: 3 Ref: 2702 Start of temporary diversion route	
Qty: 1 Ref: 2703 Direction of temporary diversion route from junction ahead	
Qty: 2 Ref: 2703 Direction of temporary diversion route from junction ahead	
Qty: 2 Ref: 7001 Road works ahead	
Qty: 2 Ref: 7010-FP-13-9 Nature of temporary hazard ahead - Road Closed	
Qty: 4 Ref: 7010-FP-13-9 Nature of temporary hazard ahead - Road Ahead Closed	

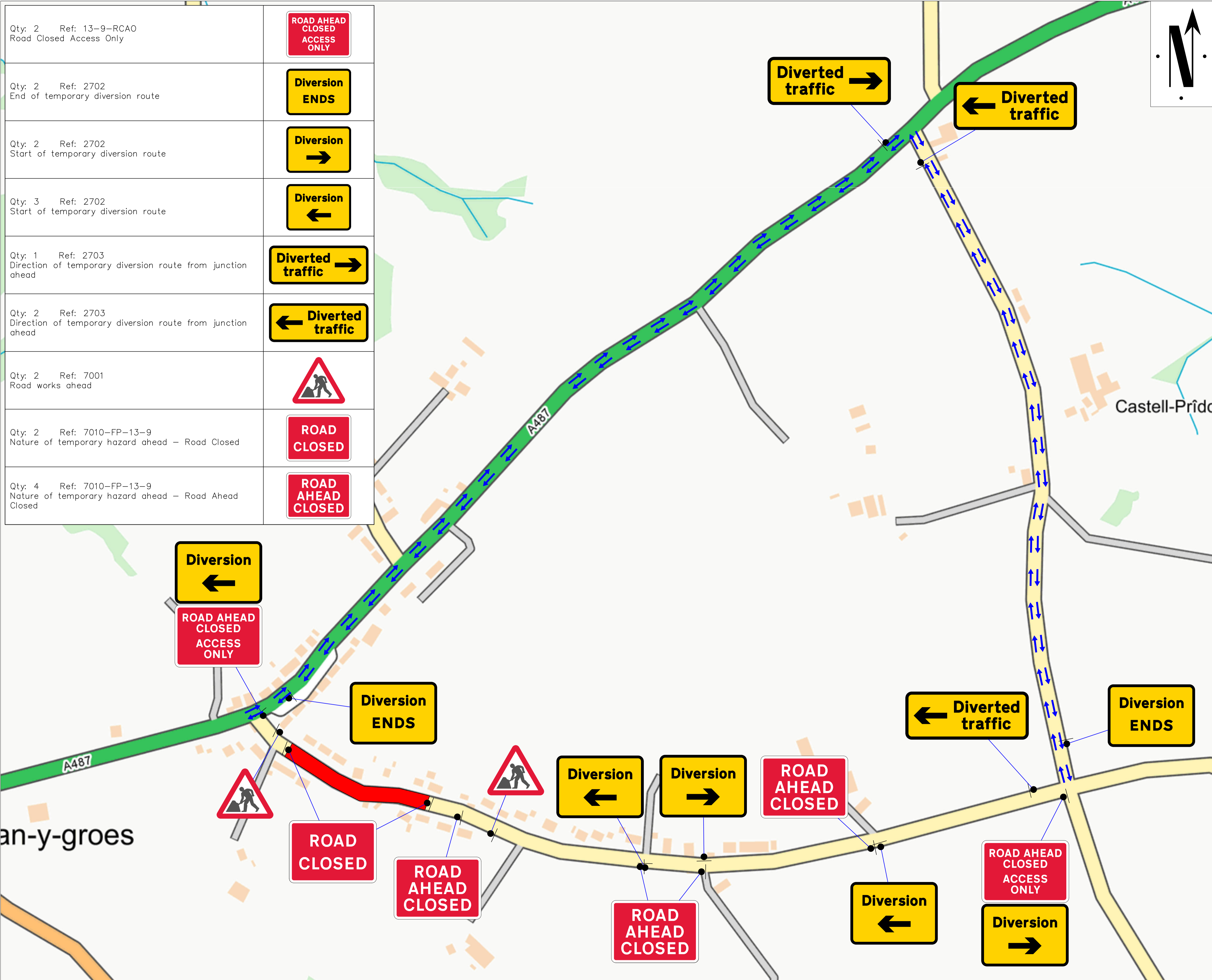

**Go Traffic Management**

This drawing has been produced for a specific client & project identified below and is not intended for use by any other person or for any other purpose. © Go Traffic Management

**Risks**

- Design completed from information provided + google maps desktop risk assessment
- Cone lamps must be used on all road with A speed limit of 40mph or more.

**Notes**

- All signs as per Chapter 8. Distances between cones to be 9m maximum unless otherwise noted.
- Distances between signs NOT to scale for purpose of clarity.
- All sign placement subject to available safe working space.
- The purpose of the Traffic Management Plan is for it to be used only as a guide and all traffic management equipment should be put out according to the 'Safety at Street Works and Road Works - Code of Practice', i.e. Red Book & the 'Traffic Signs Manual Chapter 8', i.e. Yellow Book.
- Signs must be placed in accordance with TSM and the scheme RAMS pack.
- Site conditions may have changed since the design of the drawing any changes which subsequently affect the design need to be reported by the Traffic Management Operative & any changes implemented must comply with Chapter 8.

**Key**

- Sign position and aspect of vision
- Work Space
- ← Diversion

**Road Closed**

Traffic to be diverted via:

From the closure point head East towards A487  
344 feet

turn right on A487, continue to follow A487  
0.7 miles

Turn Right and follow road  
0.5 miles

Turn right to follow the road to arrive back at closure point  
0.5 miles  
and vice versa

Minimum 1.2m Sideways & 60m Longways Safety Zone must be adhered to.

Traffic Management must comply with The Safety at Street Works and Road Works Code of Practice

**ROAD SPEED**

DO NOT SCALE FROM THIS DRAWING.

ORIGINAL	15-04-26	As Drawn
REV. A	xxx	xxx
REV. B	xxx	xxx

**GTM**  
Go Traffic Management

Head Office: Go Traffic Management,  
Chaddock Lane, Worsley, Manchester, M28 1XW  
Tel: 0161 351 5370  
www.gtm.co.uk

**CERTIFIED**  
R  
ISO 9001: ISO 14001  
OHASAS 18001

**TRAFFIC MANAGEMENT PLAN**

Client:

Drawing Number: 1754918 - 97384972  
Drawing Title: Cardigan, SA43 2JT

Design:	Technical Officer:	REV:
Name: J.Bennett		
Signature:		
Date: 15-04-2026		