













Sign Schedule		Sign Schedule	
	ID: 001 Qty: 2 Ref: 2703 Diverted traffic Size: 1112 x 731 @ 75 X-hgt		ID: 013 Qty: 3 Ref: 2702 Diversion Size: 1050 x 1000
	ID: 002 Qty: 2 Ref: 2704 Diverted traffic Size: 1130 x 731 @ 75 X-hgt		ID: 014 Qty: 5 Ref: 7010.1 Nature of temporary hazard ahead - Road Ahead Closed Size: 1176 x 938 @ 75 X-hgt
	ID: 003 Qty: 2 Ref: 2703 Diverted traffic Size: 1112 x 731 @ 75 X-hgt		ID: 015 Qty: 2 Ref: 7010.1 Nature of temporary hazard ahead - Road Closed Size: 782 x 788 @ 75 X-hgt
	ID: 004 Qty: 12 Ref: 2703 Diverted traffic Size: 962 x 731 @ 75 X-hgt		
	ID: 005 Qty: 3 Ref: 2704 Diverted traffic Size: 1130 x 731 @ 75 X-hgt		
	ID: 006 Qty: 2 Ref: 2702 Diversion Ends Size: 1050 x 1000		
	ID: 007 Qty: 4 Ref: 573 Direction to hazard right Size: 600 x 400 @ 100 X-Hgt		
	ID: 008 Qty: 4 Ref: 573 Direction to hazard left Size: 600 x 400 @ 100 X-Hgt		
	ID: 009 Qty: 9 Ref: 7001 Road works ahead Size: 750 High		
	ID: 010 Qty: 2 Ref: 13.9 Schedule 13-9 : Temporary Information Size: 970 x 1069 @ 75 X-Hgt		
	ID: 011 Qty: 4 Ref: 13.9 Schedule 13-9 : Temporary Information Size: 1177 x 1154 @ 75 X-Hgt		
	ID: 012 Qty: 3 Ref: 2702 Diversion Size: 1050 x 1000		

TRAFFIC MANAGEMENT NOTES:
 1) All temporary traffic management shall be in accordance with Chapter 8 of the Traffic Signs Manual.
 2) All temporary traffic management shall be in accordance with the Traffic Signs Regulations and General Directions 2016.
 3) All temporary traffic management shall conform to the Safety at Street Works and Road Works, A Code of Practice.
 4) All signing should be located 450mm minimum from any carriageway.
 5) All temporary traffic management sign locations are indicative and are subject to on site approval from the Engineer.

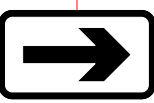
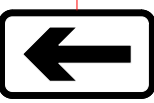

Checked by: Dave Wall

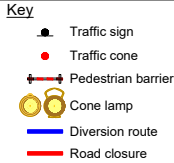
Customer: MGW LTD

Job reference: 97052468

Location: Woollen mill
Rhydlewis
SA44 5PL

QR Code:



Date: 17/09/2025

Description: Road Closure

Scale: NTS

OS HA: 0

0330 043 3030
www.corehighways.com

Produced by: Darren Grave-Weir

Design reference: DG/17.09.25/J142658

This Design is subject to Copyright and remains the property of Core Highways.
Contains Ordnance Survey data.

core
highways

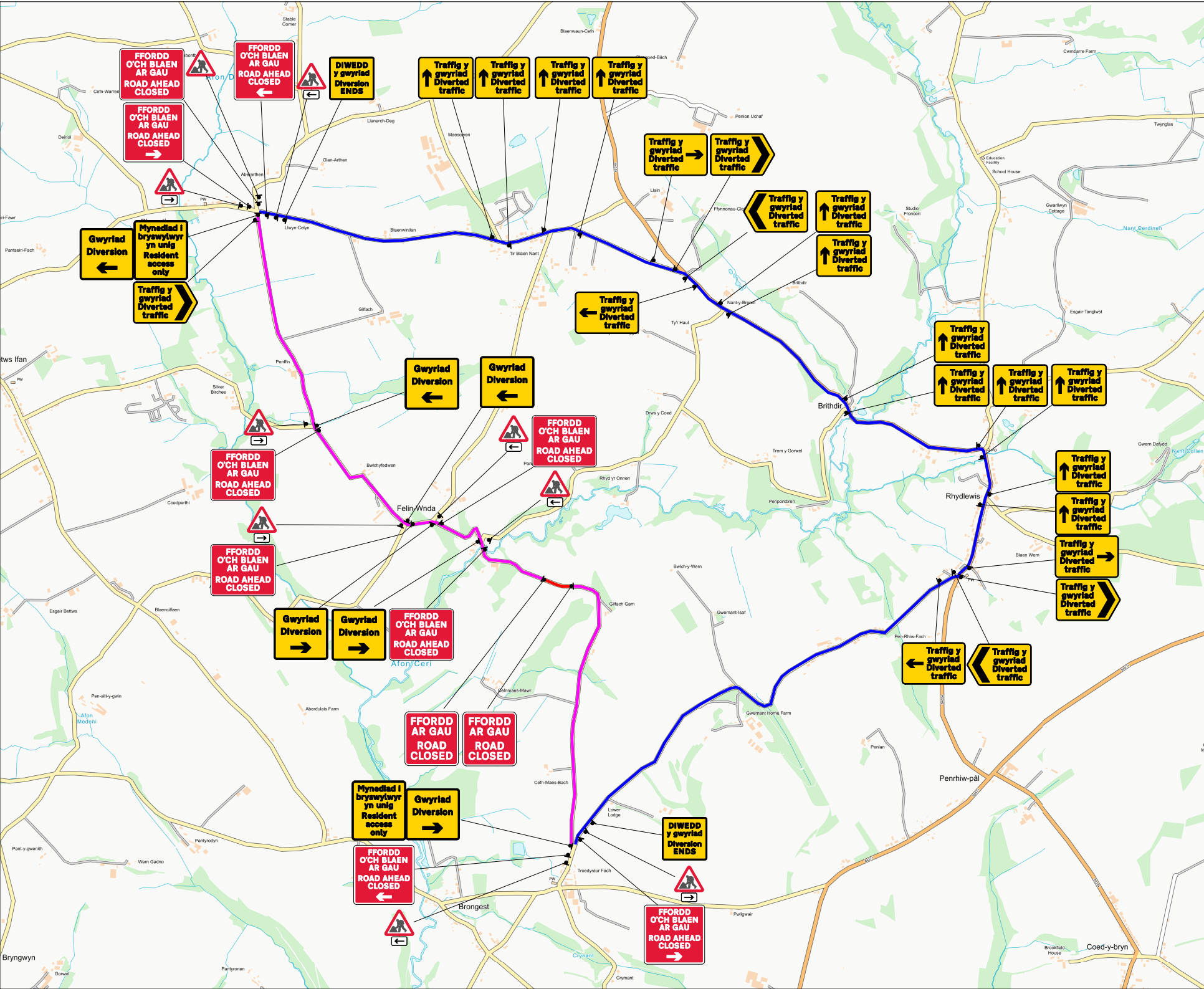

TRAFFIC MANAGEMENT NOTES:
1) All temporary traffic management shall be in accordance with Chapter 8 of the Traffic Signs Manual.
2) All temporary traffic management shall be in accordance with the Traffic Signs Regulations and General Directions 2016.
3) All temporary traffic management shall conform to the Safety at Street Works and Road Works, A Code of Practice.
4) All signing should be located 450mm minimum from any carriageway.
5) All temporary traffic management sign locations are indicative and are subject to on site approval from the Engineer.

Key

- Traffic sign
- Traffic cone
- Pedestrian barrier
- Cone lamp
- Diversion route
- Road closure

Checked by: Dave Wall	
Customer: MGW LTD	
Job reference: 97052468	
Location: Woollen mill Rhydlewis SA44 5PL	QR Code:
Date: 17/09/2025	
Description: Road Closure	
Scale: NTS	OS HA: 0
0330 043 3030 www.corehighways.com	
Produced by: Darren Grave-Weir	
Design reference: DG/17.09.25/J142658	
<small>This Design is subject to Copyright and remains the property of Core Highways. Contains Ordnance Survey data.</small>	

