

TRAFFIC MANAGEMENT NOTES:

- 1) All temporary traffic management shall be in accordance with Chapter 8 of the Traffic Signs Manual.
- 2) All temporary traffic management shall be in accordance with the Traffic Signs Regulations and General Directions 2016.
- 3) All temporary traffic management shall conform to the Safety at Street Works and Road Works, A Code of Practice.
- 4) All signing should be located 450mm minimum from any carriageway.
- 5) All temporary traffic management sign locations are indicative and are subject to on site approval from the Engineer.

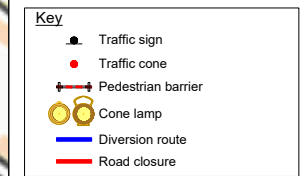

This Design is subject to Copyright and remains the property of the Crown.
Contains Ordnance Survey data.



Sign Schedule		Sign Schedule	
	ID: 001 Item: Qty: 1 Ref: 2702 Diversion Size: 1050 x 1000		ID: 008 Item: Qty: 2 Ref: 2702 Diversion Ends Size: 1050 x 1000
	ID: 002 Item: Qty: 1 Ref: 13.9 Schedule 13-9 : Temporary Information Size: 1125 x 1050 @ 100 X-Hgt		ID: 009 Item: Qty: 1 Ref: 2702 Diversion Size: 1050 x 1000
	ID: 003 Item: Qty: 1 Ref: 2704 Diverted traffic Size: 1130 x 731 @ 75 X-hgt		ID: 010 Item: Qty: 2 Ref: 7010.1 Nature of temporary hazard ahead - Road Closed Size: 782 x 788 @ 75 X-hgt
	ID: 004 Item: Qty: 1 Ref: 2703 Diverted traffic Size: 1112 x 731 @ 75 X-hgt		ID: 011 Item: Qty: 2 Ref: 573 Direction to hazard right Size: 600 x 400 @ 100 X-Hgt
	ID: 005 Item: Qty: 1 Ref: 2703 Diverted traffic Size: 1112 x 731 @ 75 X-hgt		ID: 012 Item: Qty: 1 Ref: 573 Direction to hazard left Size: 600 x 400 @ 100 X-Hgt
	ID: 006 Item: Qty: 1 Ref: 2704 Diverted traffic Size: 1130 x 731 @ 75 X-hgt		ID: 013 Item: Qty: 4 Ref: 7001 Road works ahead Size: 750 High
	ID: 007 Item: Qty: 2 Ref: 2703 Diverted traffic Size: 962 x 731 @ 75 X-hgt		ID: 014 Item: Qty: 4 Ref: 7010.1 Nature of temporary hazard ahead - Road Ahead Closed Size: 1176 x 938 @ 75 X-hgt

TRAFFIC MANAGEMENT NOTES:
1) All temporary traffic management shall be in accordance with Chapter 8 of the Traffic Signs Manual.
2) All temporary traffic management shall be in accordance with the Traffic Signs Regulations and General Directions 2016.
3) All temporary traffic management shall conform to the Safety at Street Works and Road Works, A Code of Practice.
4) All signing should be located 450mm minimum from any carriageway.
5) All temporary traffic management sign locations are indicative and are subject to on site approval from the Engineer.

Key

Traffic sign
 Traffic cone
 Pedestrian barrier
 Cone lamp
 Diversion route
 Road closure

Checked by: D. Wall

Customer: MGW LTD

Job reference: 97067297

Location: Mas Heli Southgate Aberystwyth SY23 1TD

QR Code:

Date: 18/09/2025

Description: Road Closure

Scale: NTS

OS HA: 0

0330 043 3030
www.corehighways.com

Produced by: Chris Collier-Evans

Design reference: CE/18.09.25/LL142751

This Design is subject to Copyright and remains the property of Core Highways.
Contains Ordnance Survey data.