

**Deposit of statement and plan**  
Section 31 (6) of the Highways Act 1980.

To Ceredigion County Council

I am and have been since 13th October 2006 the owner (within the meaning of the Act of the above section) of the land known as Ffynnon Wen in the county of Ceredigion, more particularly delineated on the plan accompanying this statement and thereon edged in red.

The way coloured green on the said plan has been dedicated as a bridleway  
The aforementioned land lies in the Community of Dyffryn Arth

other  
No ways over the land have been dedicated as public highways.

The deposit shall comprise this statement and accompanying plan.

**Signed (landowner)**

**Name (of landowner)**

Mrs Pamela Daly

Mr Simon John Daly

**Address (of landowner)**

Ffynnon Wen  
Bethania

Llanon  
Ceredigion SY23 5NR

**Date**

14 / 8 / 2015

**Signed (Witness)**

**Name (Witness)** Mr Gareth Morgan

**Address**

**Occupation**

27107115. N NICHOLAS 01548 572143

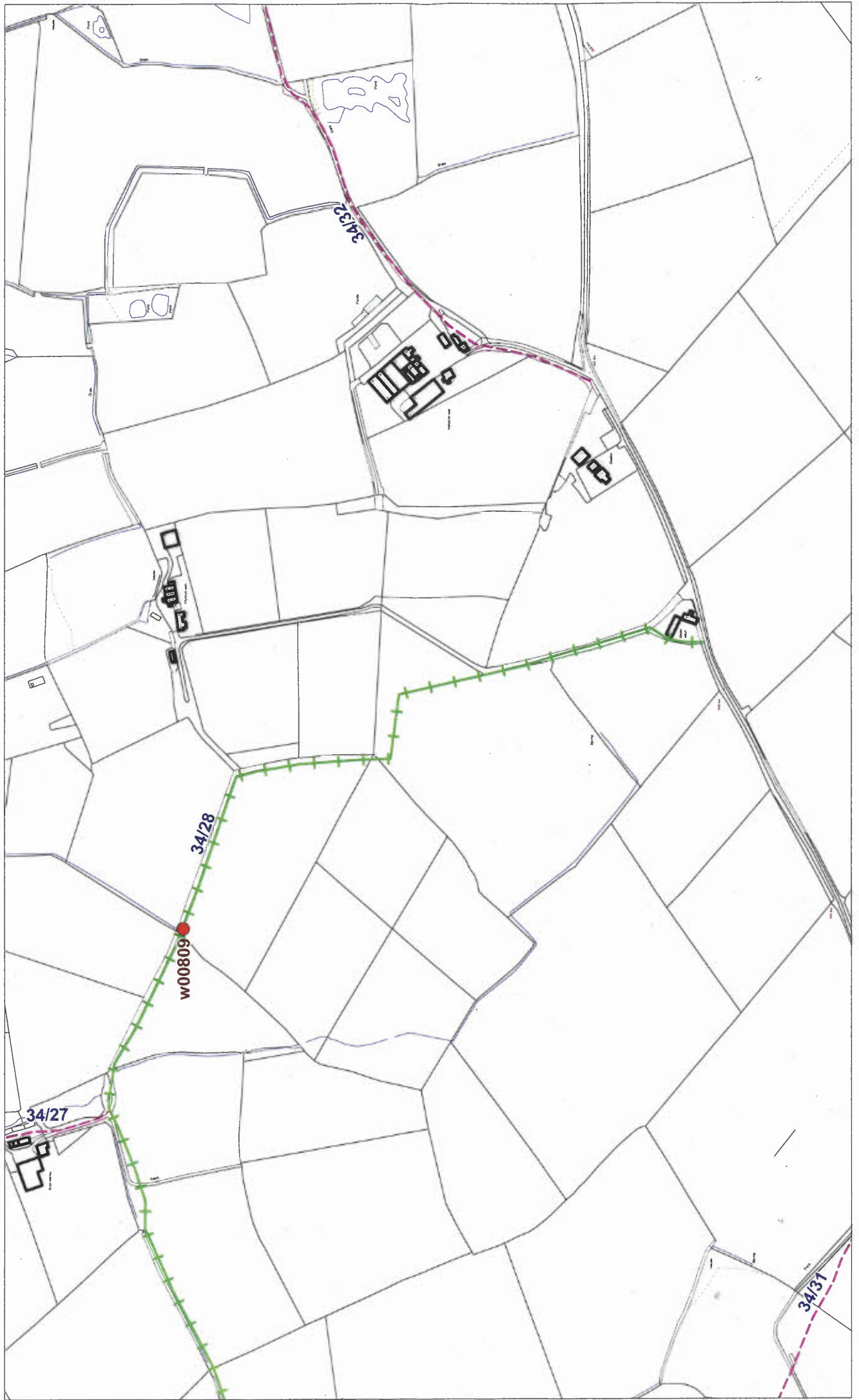



WA989079

CEREDIGION / SIR CEREDIGION

ORDNANCE SURVEY MAP REFERENCE:

SN55625E

SCALE 1:2500

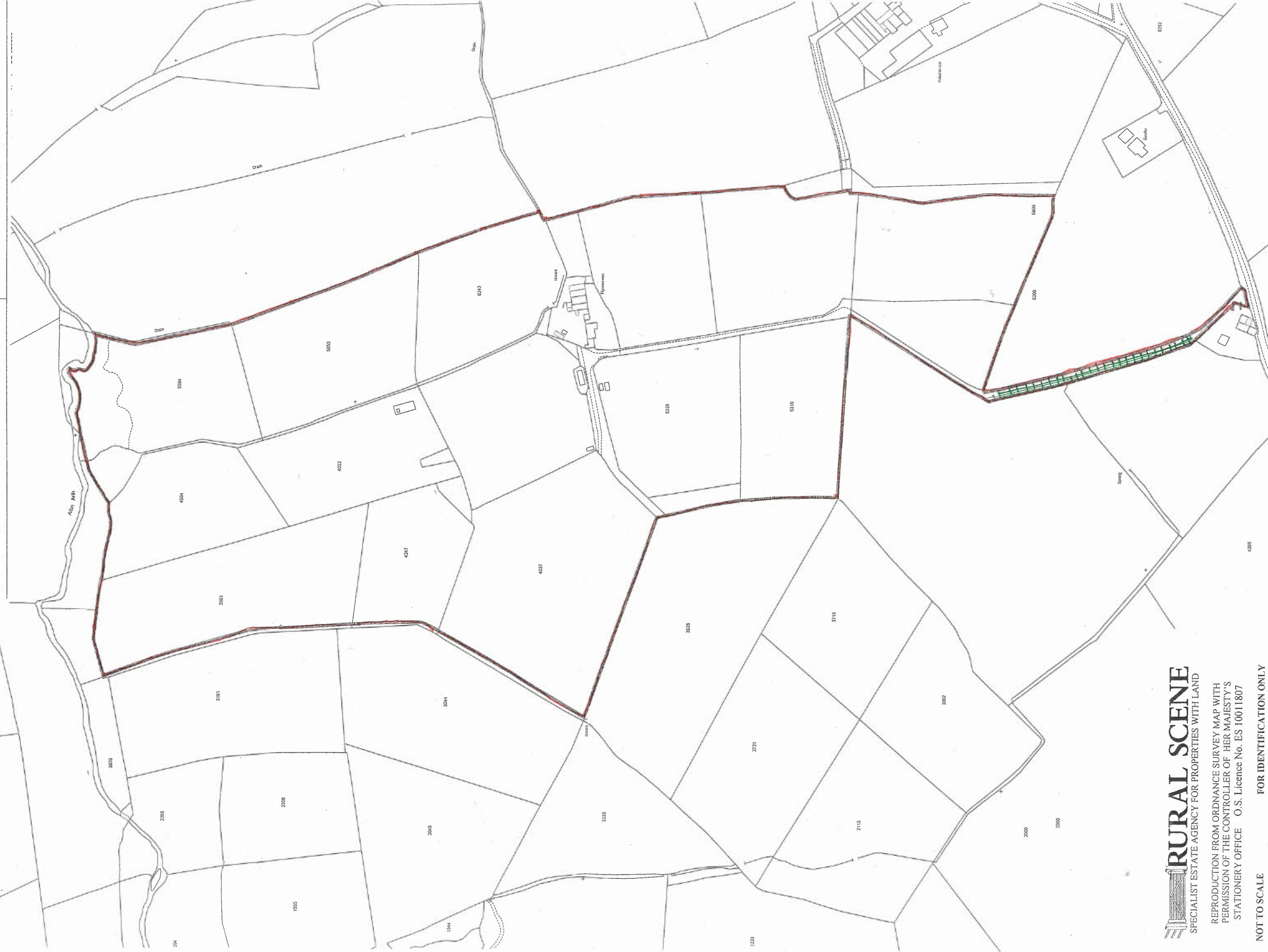
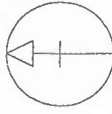

SPECIALIST ESTATE AGENCY FOR PROPERTIES WITH LAND

REPRODUCTION FROM ORDNANCE SURVEY MAP WITH PERMISSION OF THE CONTROLLER OF HER MAJESTY'S STATIONERY OFFICE O.S. Licence No. ES 10011807

NOT TO SCALE

FOR IDENTIFICATION ONLY