

Do not scale from this drawing

This drawing has been produced for the specific client and project. Identified below and is not intended for use by any other person or purpose. To scale site representation. Copyright RNR Traffic Management

Key:		Temporary Traffic Signal	
	Works Area		Stop & Go Board
	Closure		Temporary Ped Signal
	Vehicular Diversion Route		Ped Diversion Route
	Temporary Sign		Existing Bus Stop
	Cone		Temporary Sign
	Datum Point		Pedestrian Barrier

A set of stop & go boards are to be taken to site in case of traffic light failure.

Narrow verges/footways present. If signage is to be placed close to the carriageway a cone should be installed adjacent to each sign.

If/When works are to be undertaken on the footway/footpath and there is insufficient room for pedestrians, a pedestrian walkway should be installed as shown below.

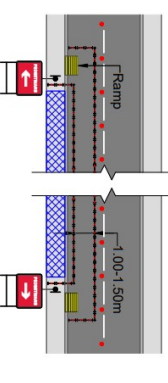

Parked vehicles/bay are present and could interfere with the works. No parking cones are to be installed prior to works commencing with appropriate signage if required.

Bus stop(s) are present/in close proximity to the works. Bus stop(s) are to be suspended and the appropriate signage installed in suitable locations to be agreed on site.

	Advance Warning Sign
	Men At Work
	Road Ahead Closed
	Road Closed
	Diversion
	Diversed Traffic
	Roundabout Signage
	Diversion End
	Cones - 30
	Subsidiary Arrow
	Men At Work End

GT WILLIAMS LTD
ENGINEERING

RNR Traffic Management

Tel: 01543 547118

Date	01/07/2025
Drawn by	JH
Draw No	6396
JOB NUMBER	WGGCJ1P
Survey by	JH
Checked by	JH
Phase No	
CLIENT	MJ QUINN
Newbridge, Ciliau Aeron, Ceredigion, Wales, SA48 7SH	
GRID REF 250331 , 258387	
WHAT 3 WORDS	
airbag.runs.emulating	

Settling out site

Distance in metres unless stated otherwise, numbers are minimum numbers	Settling out site	
Work Area	Settling out site	Settling out site
100m	100m	100m
200m	200m	200m
300m	300m	300m
400m	400m	400m
500m	500m	500m
600m	600m	600m
700m	700m	700m
800m	800m	800m
900m	900m	900m
1000m	1000m	1000m

1. The settling out site is to be located at least 100m from the work area and 100m from the road.

2. The settling out site is to be located at least 100m from the work area and 100m from the road.

3. The settling out site is to be located at least 100m from the work area and 100m from the road.

4. The settling out site is to be located at least 100m from the work area and 100m from the road.

5. The settling out site is to be located at least 100m from the work area and 100m from the road.

6. The settling out site is to be located at least 100m from the work area and 100m from the road.

7. The settling out site is to be located at least 100m from the work area and 100m from the road.

8. The settling out site is to be located at least 100m from the work area and 100m from the road.

9. The settling out site is to be located at least 100m from the work area and 100m from the road.

10. The settling out site is to be located at least 100m from the work area and 100m from the road.

11. The settling out site is to be located at least 100m from the work area and 100m from the road.

12. The settling out site is to be located at least 100m from the work area and 100m from the road.

13. The settling out site is to be located at least 100m from the work area and 100m from the road.

14. The settling out site is to be located at least 100m from the work area and 100m from the road.

15. The settling out site is to be located at least 100m from the work area and 100m from the road.

16. The settling out site is to be located at least 100m from the work area and 100m from the road.

17. The settling out site is to be located at least 100m from the work area and 100m from the road.

18. The settling out site is to be located at least 100m from the work area and 100m from the road.

19. The settling out site is to be located at least 100m from the work area and 100m from the road.

20. The settling out site is to be located at least 100m from the work area and 100m from the road.

21. The settling out site is to be located at least 100m from the work area and 100m from the road.

22. The settling out site is to be located at least 100m from the work area and 100m from the road.

23. The settling out site is to be located at least 100m from the work area and 100m from the road.

24. The settling out site is to be located at least 100m from the work area and 100m from the road.

25. The settling out site is to be located at least 100m from the work area and 100m from the road.

26. The settling out site is to be located at least 100m from the work area and 100m from the road.

27. The settling out site is to be located at least 100m from the work area and 100m from the road.

28. The settling out site is to be located at least 100m from the work area and 100m from the road.

29. The settling out site is to be located at least 100m from the work area and 100m from the road.

30. The settling out site is to be located at least 100m from the work area and 100m from the road.

31. The settling out site is to be located at least 100m from the work area and 100m from the road.

32. The settling out site is to be located at least 100m from the work area and 100m from the road.

33. The settling out site is to be located at least 100m from the work area and 100m from the road.

34. The settling out site is to be located at least 100m from the work area and 100m from the road.

35. The settling out site is to be located at least 100m from the work area and 100m from the road.

36. The settling out site is to be located at least 100m from the work area and 100m from the road.

37. The settling out site is to be located at least 100m from the work area and 100m from the road.

38. The settling out site is to be located at least 100m from the work area and 100m from the road.

39. The settling out site is to be located at least 100m from the work area and 100m from the road.

40. The settling out site is to be located at least 100m from the work area and 100m from the road.

41. The settling out site is to be located at least 100m from the work area and 100m from the road.

42. The settling out site is to be located at least 100m from the work area and 100m from the road.

43. The settling out site is to be located at least 100m from the work area and 100m from the road.